

vax

DynamoPower
TOTAL HOME

DYNAMIC POWERFUL
PERFORMANCE, FOR TOTAL
HOME CLEANING



LET'S GET STARTED.

2 YEAR WARRANTY

VX54

vax.com.au
vax.co.nz

Let's talk safety



Basic safety precautions

This vacuum cleaner is intended for household use only and NOT for commercial or industrial use.

READ ALL THE INSTRUCTIONS BEFORE USING THIS APPLIANCE

- Only use the vacuum cleaner indoors and keep the area you're cleaning well lit.
- Keep fingers, hair and loose clothing from moving parts and openings whilst using the vacuum cleaner.
- This appliance is not intended for use by persons (including children) with reduced physical, sensory or mental capabilities or lack of experience and knowledge unless they have been given supervision or instruction concerning use of the appliance by a person responsible for their safety.

Children should not play with the vacuum cleaner. Cleaning and user maintenance should not be made by children without supervision

- Only Vax recommend tools and accessories should be used with this vacuum cleaner
- Vax recommends the use of a Residual Current Device rating of 30 mA or less.
- If the supply cord is damaged, it must be replaced by the manufacturer, or similarly qualified person in order to avoid a hazard, or invalidating the warranty.
- **IMPORTANT:** The motor is equipped with a thermal cut-out. If for any reason the unit should overheat, the thermostat will automatically turn the unit off. Should this occur, unplug the vacuum cleaner from the electrical outlet and turn off the switch. Remove dirt container and empty. Clean filters. Allow the unit to cool for approximately one (1) hour. To re-start, plug into an electrical outlet and switch back on.



Don'ts

- Do not pull or carry by cord, use cord as a handle, close a door on cord, or pull cord around sharp edges or corners. Do not place product on cord. Do not run appliance on cord.
- Don't handle the plug or use the vacuum cleaner with wet hands.
- Don't use the vacuum cleaner with incorrect voltage as this may result in damage or injury to the user. The correct voltage is listed on the rating label.
- Don't vacuum up hot coals, cigarette butts, ash, matches or smoking hot burning items or use in an area where there may be harmful fluids (chlorine, bleach, and ammonia drain cleaner).

- Don't attempt to remove blockages with sharp objects as this may cause damage to the vacuum cleaner.
- Do not vacuum hard or sharp objects such as glass, nails, screws or coins etc.
- Do not vacuum plaster dust, concrete dust or any other building or vitreous material.
- Do not vacuum flour, baking soda or any other powder-based carpet refresher or deodoriser.
- Don't use this vacuum cleaner if it has been dropped, damaged or left outdoors.
- Don't vacuum up any flammable or combustible materials (lighter fluid, petrol, kerosene etc.) or use the vacuum cleaner in an area with explosive vapours or liquid.



Do's

- Always make sure the filter and dirt container are fitted correctly before using your vacuum cleaner.
- Turn off all controls on the vacuum cleaner before disconnecting or connecting the battery.
- Take extra care when cleaning on the stairs.
- Always switch off the vacuum cleaner before disconnecting or connecting the hose and accessories.
- Always protect the charger cord from heated surfaces or near open flames.

- Use only SAA approved 10amp extension cords. Care should be taken to arrange the extension cord as it can be a trip hazard.
- Always carry the vacuum cleaner by the handle.
- Store your vacuum cleaner in a cool, dry area.
- Always keep the power cord away from the brushes whilst using your vacuum cleaner.

PLEASE KEEP INSTRUCTIONS FOR FURTHER USE.

Thank you for buying this Dynamo Power Total Home.

Taking care of your carpets and hard floors

The Dynamo Power Total Home is designed to make vacuuming carpets and hard floors regularly, as effective and efficient as possible and this user guide will help you get the most out of your machine.

Maintaining your carpets and hard floors will ensure they keep their appearance for longer. You've chosen carpets and hard floors for your home for a reason and Vax will help you take good care of them.

Taking care of your Dynamo Power Total Home

Also inside this guide are instructions on maintaining your new machine, so that it's always ready when you are to tackle your carpets and hard floors.

We're here if you need us

For troubleshooting simply visit or call:

Australia: 1300 361 505*
vax.com.au

New Zealand: 0800 800 900*
vax.co.nz

*Monday – Friday: 8:30am -5:00pm

Calls are charged at the standard local rate. Please make note of the serial number and model number of the product before calling.



Contents

- Let's talk safety
- Getting to know your machine
- Getting started
- Using your machine
- Taking care of your machine
- Let's talk technical
- Accessories
- Notes
- What to do if it goes wrong
- Getting in touch

Dynamo Power Total Home

Included with your machine

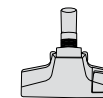

Combination Floorhead

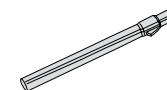

Telescopic Extension Tube



3-in-1 Tool



Accessory Hose



Hardfloor Tool



TurboTool



Turbo Brush



Up-top Tool



PLEASE READ 'LET'S TALK SAFETY' AT THE BEGINNING BEFORE USE

Before you begin cleaning

- Always switch off and unplug the vacuum cleaner before connecting or disconnecting the hose/attachments, or removing and emptying the dirt container.
- The vacuum cleaner is equipped with a thermal cut-out. If for any reason the vacuum cleaner does overheat the thermostat will automatically turn the vacuum cleaner off. If this happens, switch the vacuum cleaner off and unplug from electrical socket. Remove and empty the dirt container also check the vacuum cleaner for blockages. Allow the vacuum cleaner to cool for approximately 1 hour (if you have cleaned the filters please wait 24 hours for the filters to fully dry before putting back into the vacuum machine).
- For best cleaning results, filters should be tapped over a bin every 4-6 uses to remove dirt and debris and washed every 3 to 6 months (depending on the level of use).
- If the vacuum cleaner is blocked, switch off and unplug before removing the blockage.

Assembling your vacuum cleaner

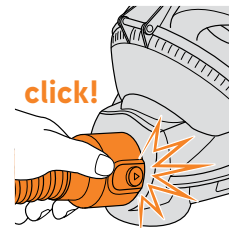

Press both buttons at the end of the hose and push hose into the hose entry point.

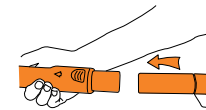

Insert the hose grip into the telescopic extension tube.

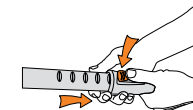

Press the button on the telescopic extension tube and adjust to required length.

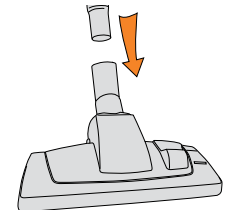

Insert the other end of the telescopic extension tube into the floor head.

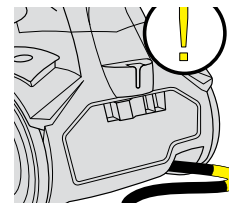

Fully unwind the power cord. A yellow mark on the cord indicates the recommended cord length. Do not exceed the cord beyond the yellow mark.

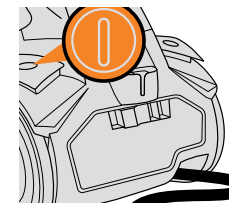

Plug in and switch the unit on by pressing the power button.

When unwinding the power cord always pull out to the yellow marker but no further.

CAUTION



Technical Specification

Name **Dynamo Power Total Home**
 Voltage **220-240V-50Hz**
 Wattage **1600w**
 Cord length **6m**
 Weight **5.2kg**

Accessories & Consumables

Filter pack*
VX54F



CAUTION: The base of the vacuum cleaner should always be positioned flat on the floor when starting and in use. The dirt container should be locked into place before lifting the vacuum cleaner by the carry handle.

How to use

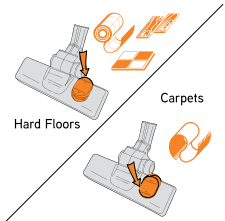

For use on carpets, click rocker switch forward.
For use on hard floors click rocker switch back.

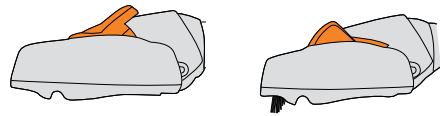

Raise brushes for carpets.

Lower brushes for hard floors.

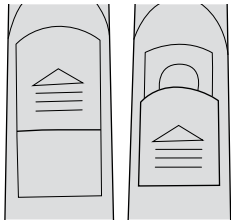

Slide vent cover on hose grip open to reduce suction if required.

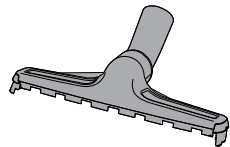

For the **most efficient** results on hard floors replace the combination floorhead with the specialist hard floor tool.

Using accessories

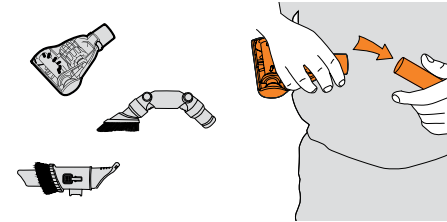

Choose an accessory.

Choose an accessory and push onto the telescopic extension tube or hose.

Storage

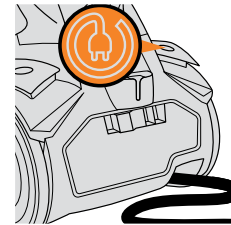

Press the cord rewind button to retract the cord into the vacuum cleaner.

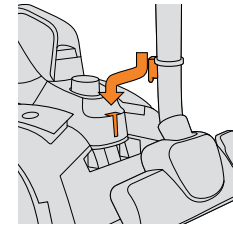

Place the floorhead into the parking slot on the back of the vacuum cleaner for storage and carrying.

CAUTION: Make sure to hold the cord with your other hand to prevent injury when rewinding.

Taking care of your machine

IMPORTANT: Always switch off and unplug the vacuum cleaner from the electrical socket before assembling, opening or emptying the dirt container, or before connecting/disconnecting the attachments.

Pre-motor filter should be tapped over a bin every 4-6 uses to remove dirt and debris. Do not use your vacuum cleaner without all of the filters in place.

The motor is equipped with a thermal cut-out. If for any reason the unit should overheat, the thermostat will automatically turn the unit off.

Emptying and cleaning the dirt container

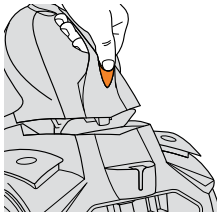

Remove dirt container by pushing down the dirt container release button and lifting the dirt container.

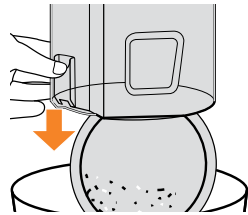

Hold the dirt container over a bin. Push down the dirt release clip at the bottom of the dirt container. The dirt release door will open allowing dirt/debris to fall out.

Don't over fill the dirt container to avoid blocking the air flow through the vacuum cleaner.



Cleaning the Pre-motor filter

CAUTION: Incorrect fitting of the separator cap will reduce suction.



Lift the dirt bin lid release clip. In a hinge like manner lift open the dirt bin lid.



Pull the filter tab and remove the pre-motor filter.

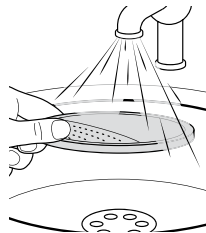

Tap the filter over a bin to remove any dirt/debris. Wash the filter under running water (40 degrees max).

Taking care of your machine

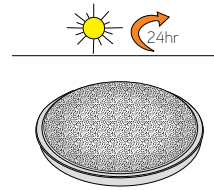

Leave for 24 hours or until fully dry before replacing.

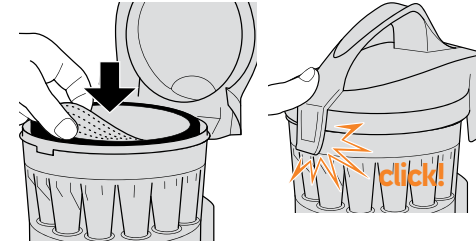

Refit the pre-motor filter into the dirt container with the tab being visible.

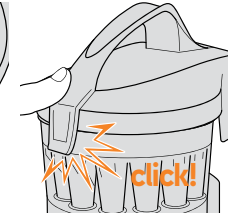

In a hinge like manner close the dirt bin lid until it clicks into place.

Post-motor filter maintenance

IMPORTANT: The post motor filter is designed to offer long life with no maintenance. The filter should be checked periodically and when heavily discoloured it should be replaced. Please do not wash, scrub or brush the filter as this will damage the filter.

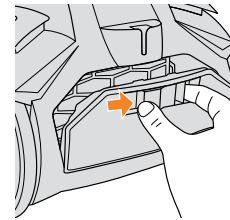

Push the post-motor filter cover release clip to the right to remove the post motor filter cover.

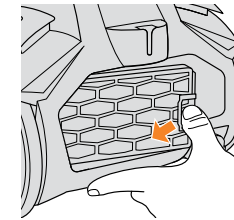

Pull the post motor filter to the left and remove the post motor filter.

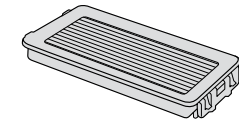

Check the post motor filter for discolouration. Do not wash the post motor filter.

Cleaning the separator, shroud and separator plate

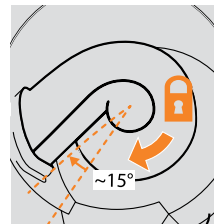

After emptying the dirt container, twist the separator clockwise to unlock and lift to remove.

Taking care of your machine

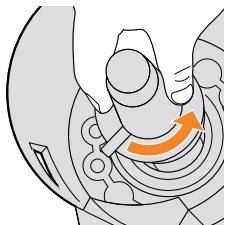

Unscrew the shroud anti clockwise and remove.

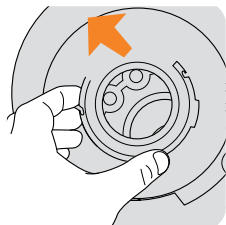

Pull to remove the separator plate.



Tap the separator, shroud and separator plate over a bin to remove any dirt/debris. Using a dry cloth wipe the remaining dirt /debris from the separator, shroud and separator plate.

Re-fitting the separator plate, shroud plate

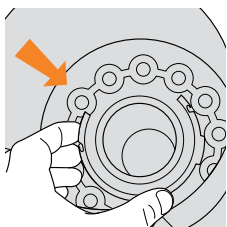

Line up and push the separator plate into place.

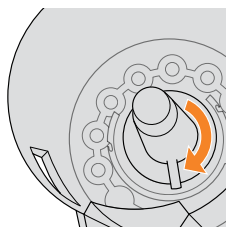

Refit the shroud twisting clockwise to lock into place.

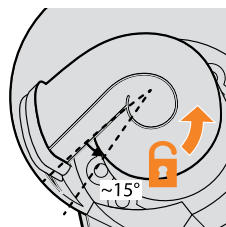

Line up the separator making sure both rectangular holes in the dirt container and separator line up.

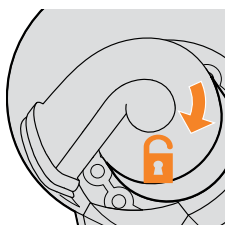

Twist the separator anti clockwise to lock into place.

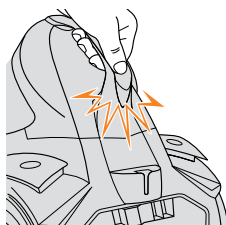

Refit the dirt container pushing down firmly until it clicks and locks into place.

Let's talk technical

Removing blockages from the TurboTool

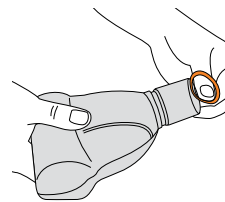

Slide the locking ring to remove.

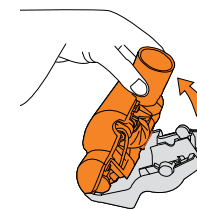

Lift and separate the housing.

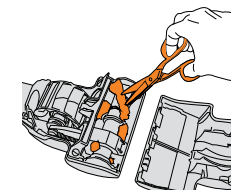

Using a pair of scissors, cut any hair or debris free from around the brushes.

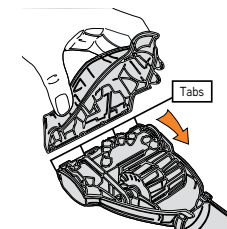

Line up the tabs on front of housing and push together to refit. Slide locking ring into groove to secure.

Removing blockages from the Turbobrush

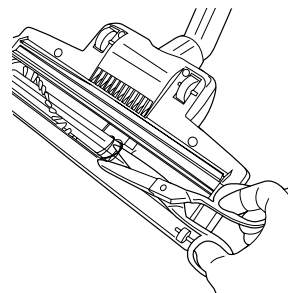

Switch the vacuum cleaner off and disconnect the power plug from the electrical outlet.

Lay the Turbobrush on a flat surface and turn over to expose the brushbar. Using a pair of scissors, cut through any threads or hairs caught around the brushes and brushbar.

Removing blockages from the hose

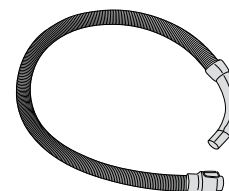

Remove the hose from the vacuum cleaner and telescopic extension tube. Insert a broom handle or similar blunt instrument into the hose to remove blockage.

To test for a blockage in the hose, drop a small ball of paper into the hose. The paper will drop through if the hose is clear.



Don't forget your accessories!

Order at: www.vax.com.au / www.vax.co.nz

Pro Cleaning Kit Model no. VPCK

Crevice tool

For awkward gaps and crevices.

Upholstery attachment

Gently cleans large areas of upholstery, curtains, sofas and chairs.

Pet hair removal attachment

Tackles stubborn pet hair on furniture, rugs and carpets.

Stubborn dust brush attachment

Removes built up dust from skirting, banisters and corners.



Radiator Tool

Long slim design, is perfect for cleaning behind and inside the radiator.



Up Top Tool

Ideal for reaching those hard to reach high areas.



Mattress Tool

Quickly and easily removes embedded dust from mattresses.



Soft Brush

Gently removes dust and dirt from delicate surfaces such as tiles and glass without scratching.



Filter Pack

Model no. VX54F

Includes pre-motor filter and post-motor filter.





Notes

Notes 

Problem

Solution

There is an accessory missing

- Check the 'This pack contains' panel on the box to make sure the part is included with your vacuum cleaner.

Why won't the vacuum cleaner pick up?

- The dirt container may not be correctly fitted, remove the dirt container from the vacuum cleaner and check it's assembled correctly, refit ensuring it's locked into place.
- The separator/shroud are blocked. Go to 'Taking care of your machine'
- The separator/shroud are incorrectly fitted. Go to 'Taking care of your machine'
- The filter may be clogged, clean the filter. Go to 'Taking care of your machine'.
- The dirt container may be blocked, empty the dirt container. Go to 'Taking care of your machine'.
- There may be a blockage in the hose/tube. Disconnect from the vacuum cleaner and carefully remove any blockages. Go to 'Let's talk technical'.

Why does my vacuum cleaner have no power?

- The plug may not be fully pushed into the electrical socket.
- The motor thermostat may have tripped. If this has happened, unplug the vacuum cleaner. Remove and empty the dirt container and check the hose for blockages. Clean the filters and allow the vacuum cleaner to cool for approximately 1 hour (if you have washed the filters you will need to wait 24 hours for the filters to fully dry before putting them back into the vacuum cleaner).

Why is dust escaping from the vacuum?

- The filters may be clogged, clean the filter. Go to 'Taking care of your machine'.

IMPORTANT: To reduce the risk of personal injury, unplug the vacuum before performing maintenance/troubleshooting checks.

Taking care of you

We're here if you need us. For trouble shooting, simply call or visit:

Australia: 1300 361 505*

vax.com.au

New Zealand: 0800 800 900*

vax.co.nz

*Monday-Friday 8.30am to 5.00pm

* Calls are charged at the standard local rate. Please make a note of the serial number and model number of the vacuum cleaner before calling.

vax

Distributed by Techtronic Industries Australia Pty. Ltd.
31 Gilby Road, Mt Waverley, VIC 3149 Australia.
Careline AU: 1300 361 505 www.vax.com.au
Careline NZ: 0800 800 900 www.vax.co.nz